

AMENDMENTS:		
AMENDMENT	DATE	DESCRIPTION

- NOTES:
- 1) This plan has been prepared for sewer asbuilt purposes only. No liability is accepted if the plan is used for any other purpose.
 - 2) Any measurements taken from information which is not dimensioned on the electronic copy are at the risk of the recipient.
 - 3) All sewer laterals are Ø100mm uPVC SN16. All Ø150mm uPVC sewer mains are SN16.
 - 4) All lateral positions have been provided by Rooney Group Ltd and have not been verified. No liability is accepted in relation to their locations.
 - 5) Origin of Levels:
 SS 11A SO 797
 Brass Plaque
 RL=9.42m

 All levels in terms of Lyttelton Vertical Datum 1937. Levels pre 2010 & 2011 Canterbury earthquakes.
 - 6) All roading and footpath information is asbuilt.

LEGEND

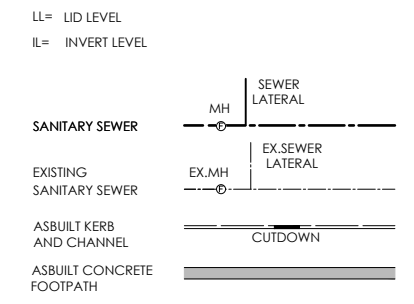

DAVIE LOVELL-SMITH
 PLANNING SURVEYING ENGINEERING

116 Wrights Road P O Box 679 Christchurch 8140, New Zealand
 Telephone: 03 379-0793 Website: www.dls.co.nz E-mail: office@dls.co.nz

JOB TITLE:
Rosemerryn - Stage 21B

SHEET TITLE:
Sewer Asbuilt

DRAWING STATUS:
Asbuilt

SCALE: 1:500@A1
 1:1000@A3 DATE: August 2024

CAD FILE: J:\20764\ASBUILTS\STG 21B\E20764_STG21B_AB_NZTM_R0.dwg DRAWN: JS
 DRAWING No: **E.20764.AB.SS01** SHEET No: **RO** REVISION:

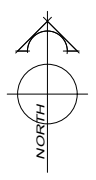
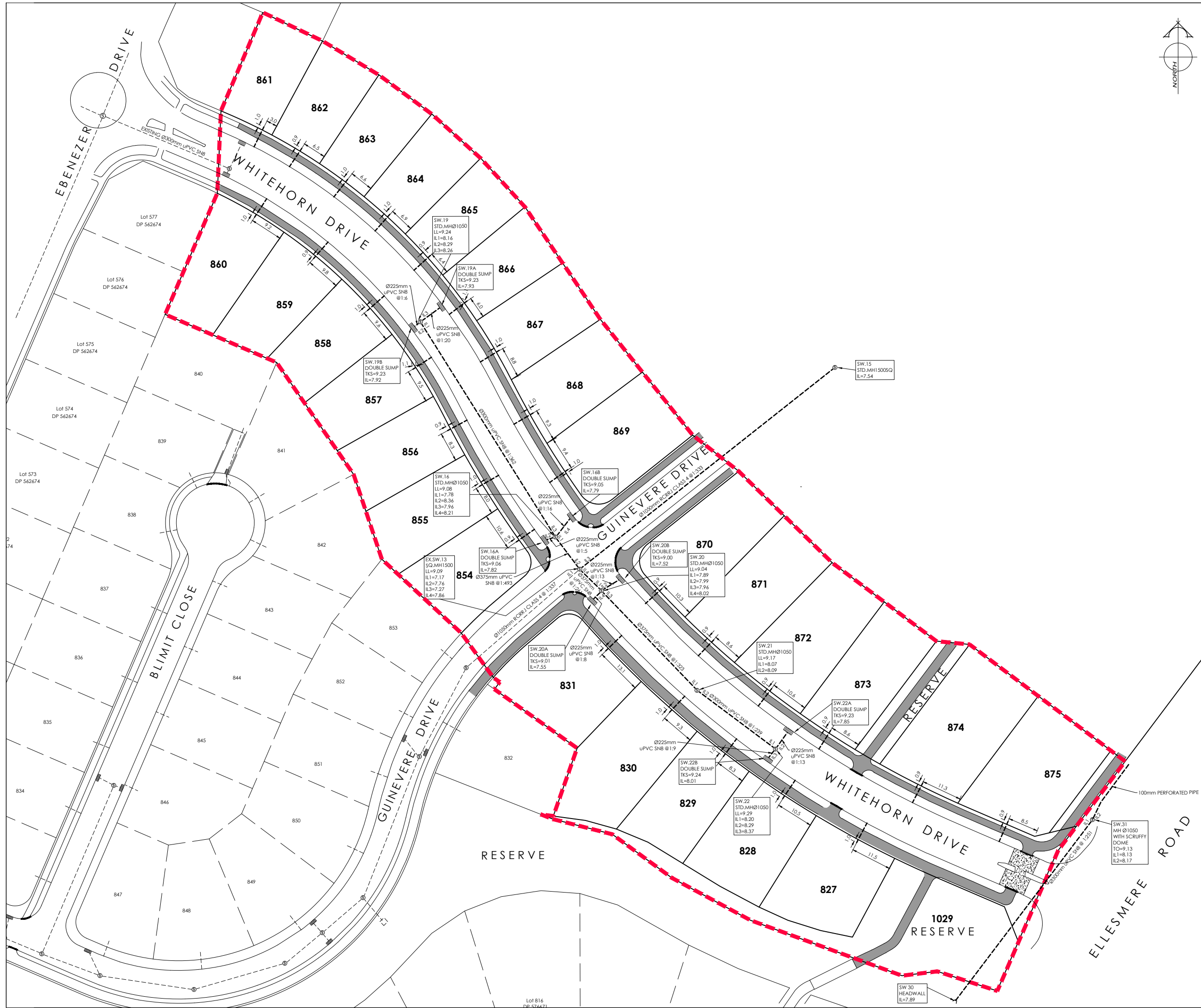

AMENDMENTS:		
AMENDMENT	DATE	DESCRIPTION

NOTES:

- 1) This plan has been prepared for stormwater asbuilt purposes only. No liability is accepted if the plan is used for any other purpose.
- 2) Any measurements taken from information which is not dimensioned on the electronic copy are at the risk of the recipient.
- 3) All connections to kerb adaptors are evident on site.
- 4) All stormwater pipes up to Ø525mm are uPVC SN8. All concrete pipes are Class 4.
- 5) All stormwater laterals are Ø100mm uPVC SN16.
- 6) Stormwater lateral locations have been provided by Rooney Group Ltd and have not been verified. No liability is accepted in relation to their accuracy.
- 7) Origin of Levels:
SS 11A SO 797
Brass Plaque
RL=9.42m

All levels in terms of Lyttelton Vertical Datum 1937.
Levels pre 2010 & 2011 Canterbury earthquakes.
- 8) All roading and footpath information is asbuilt.

LEGEND

LL=	LID LEVEL
TO=	TOP OVER LEVEL
IL=	INVERT LEVEL
TKS=	TOP OF KERB LEVEL AT SUMP
STORMWATER	
EXISTING STORMWATER	
ASBUILT KERB AND CHANNEL	
ASBUILT CONCRETE FOOTPATH	



116 Wrights Road P O Box 679 Christchurch 8140, New Zealand
Telephone: 03 379-0793 Website: www.dls.co.nz E-mail: office@dls.co.nz

JOB TITLE:
Rosemerryn - Stage 21B

SHEET TITLE:
Stormwater Asbuilt

DRAWING STATUS:
Asbuilt

SCALE: 1:500@A1
1:1000@A3 DATE: August 2024

CAD FILE: J:\20764\ASBUILTS\STG 21B\E20764_STG21B_AB_NZTM_R0.dwg DRAWN: JS
DRAWING No.: SHEET No.: REVISION:
E.20764.AB.SW01 RO

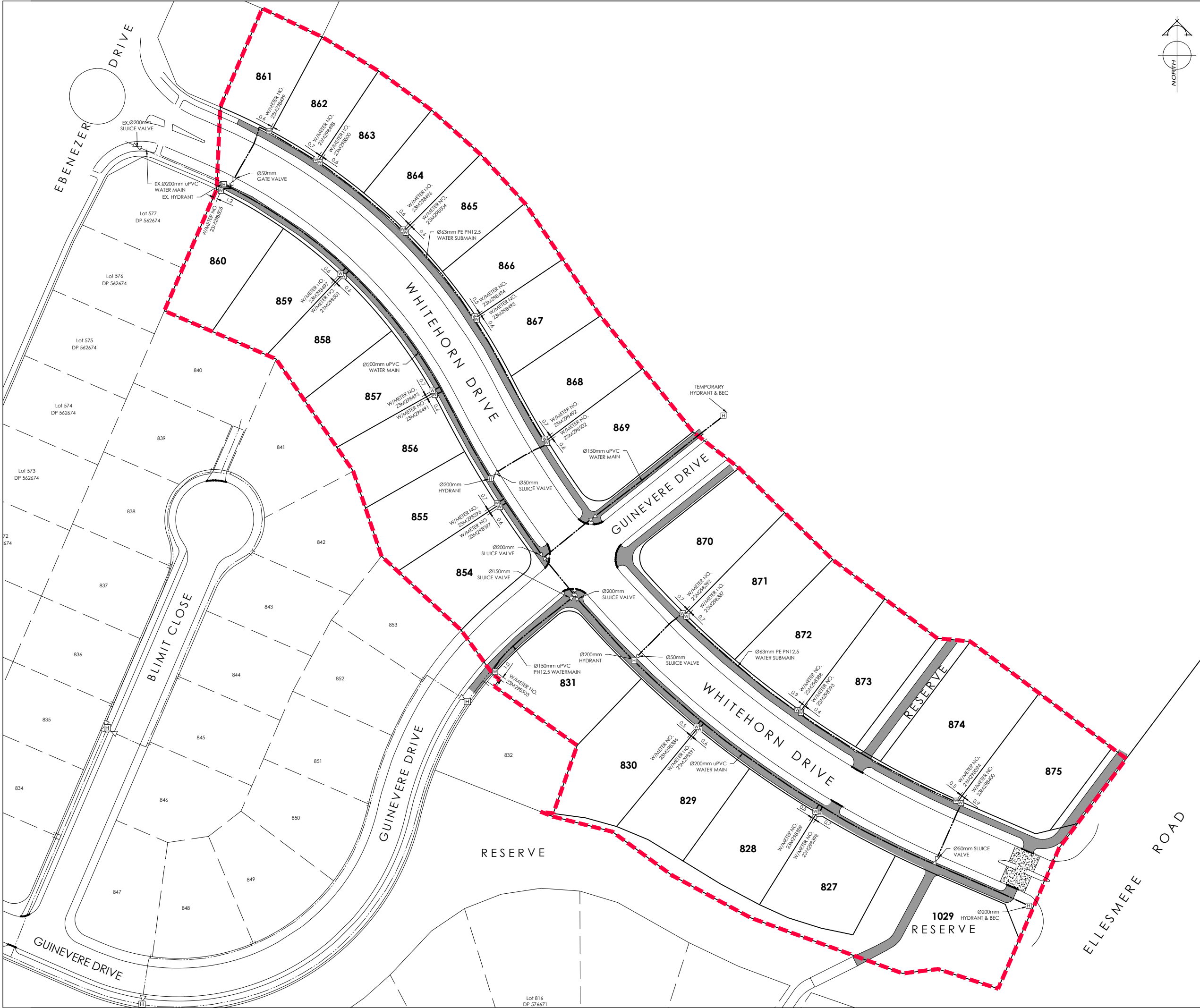

AMENDMENTS:		
AMENDMENT	DATE	DESCRIPTION

- NOTES:
- 1) This plan has been prepared for water asbuilt purposes only. No liability is accepted if the plan is used for any other purpose.
 - 2) Any measurements taken from information which is not dimensioned on the electronic copy are at the risk of the recipient.
 - 3) All submains are Ø63mm (OD) PE BlueLine PN12.5 with associated fittings.
 - 4) All house connections are 25mm poly and include gate valve, toby box, tapping band and ferrule.
 - 5) All water laterals are Ø25mm PE BlueLine PN12.5 with associated fittings unless otherwise specified.
 - 6) All watermains are uPVC PN12.
 - 7) All roading and footpath information is asbuilt.
 - 8) The locations of submains and watermains have been provided by Rooney Group Ltd. No liability is accepted in relation to their accuracy.

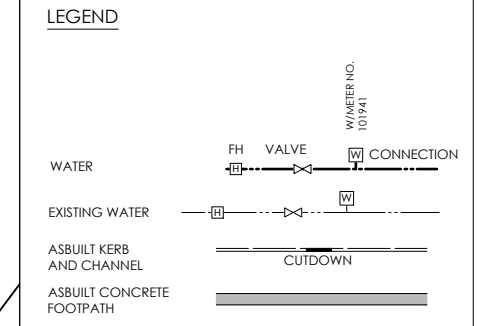

DAVE LOVELL-SMITH
PLANNING SURVEYING ENGINEERING

116 Wrights Road P O Box 679 Christchurch 8140, New Zealand
Telephone: 03 379-0793 Website: www.dls.co.nz E-mail: office@dls.co.nz

JOB TITLE:
Rosemerryn - Stage 21B

SHEET TITLE:
Water Asbuilt

DRAWING STATUS:
Asbuilt

SCALE: 1:500@A1
1:1000@A3 DATE: August 2024

CAD FILE: J:\20764\ASBUILTS\STG 21B\E20764_STG21B_AB_NZTM_R0.dwg DRAWN: JS
DRAWING No: **E.20764.AB.WS01** SHEET No: **RO** REVISION:

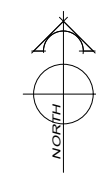

AMENDMENTS:		
AMENDMENT	DATE	DESCRIPTION

- NOTES:
1. This plan has been prepared for road asbuilt purposes only. No liability is accepted if the plan is used for any other purpose.
 2. Any measurements taken from information which is not dimensioned on the electronic copy are at the risk of the recipient.
 3. Carriageway dimensions shown are from face of kerb to face of kerb.
 4. All roading information is asbuilt.

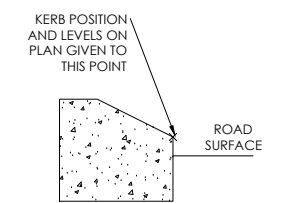

**IN SITU MOUNTABLE MEDIAN
KERB TO CCC SD603**

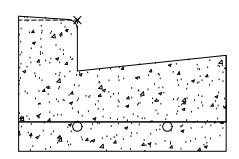

KERB & CHANNEL TO SD601

LEGEND

EXPOSED AGGREGATE	
ASBUILT KERB AND CHANNEL	
ASBUILT CONCRETE FOOTPATH	



116 Wrights Road P O Box 679 Christchurch 8140, New Zealand
Telephone: 03 379-0793 Website: www.dls.co.nz E-mail: office@dls.co.nz

JOB TITLE:
Rosemerryn - Stage 21B

SHEET TITLE:
Roading Asbuilt

DRAWING STATUS:
Asbuilt

SCALE: 1:500@A1
1:1000@A3 DATE: August 2024

CAD FILE: J:\20764\ASBUILTS\STG 21B\E20764_STG21B_AB_NZTM_RD.DWG DRAWN: JS
DRAWING No: **E.20764.AB.RD01** SHEET No: **RO** REVISION: